

PLAINVIEW, TX

explore the opportunities

CITY OF PLAINVIEW ZONING DEPARTMENT STORAGE AND ACCESSORY BUILDINGS

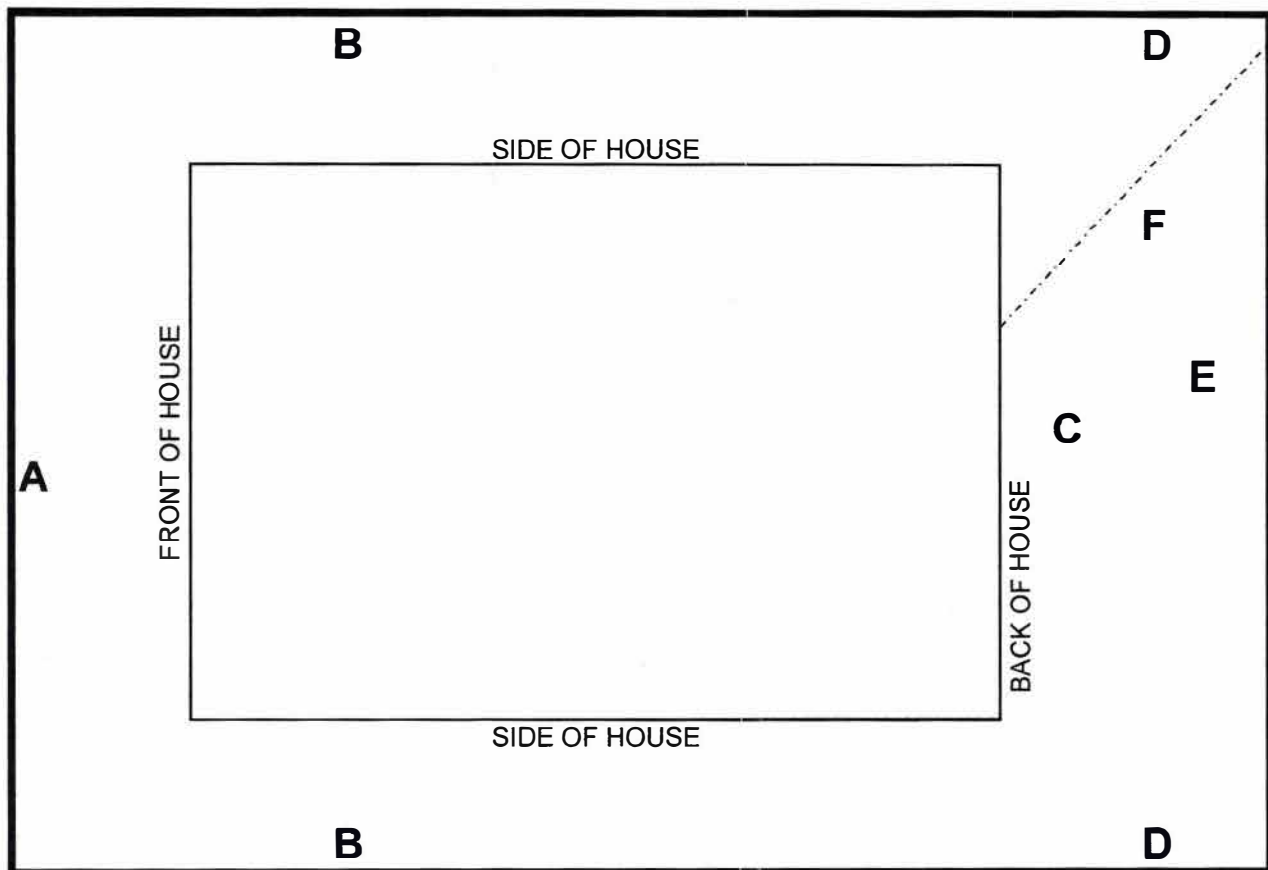

- A. No storage or accessory building is permitted in the front yard.
- B. Storage buildings in the side yard must be 10' from the house and 3' from the side property line.
- C. Building must be 10' from the house.
- D. Building must be 3' from the property line.
- E. The eave of the building can touch the rear property line if no water drains off of the eave. If water drains off of eave, it has to drain onto your property first.
- F. Overhead electrical service lines passing over building must be 8' from peak of roof.
- G. Building cannot be built on top of utilities (water, electric, gas, sewer).
- H. All buildings must be anchored.
- I. If building is over 200 square feet it will require a building permit.
- J. Regardless of building size A-H applies to all buildings.